

# SEQUENCE OF OPERATIONS

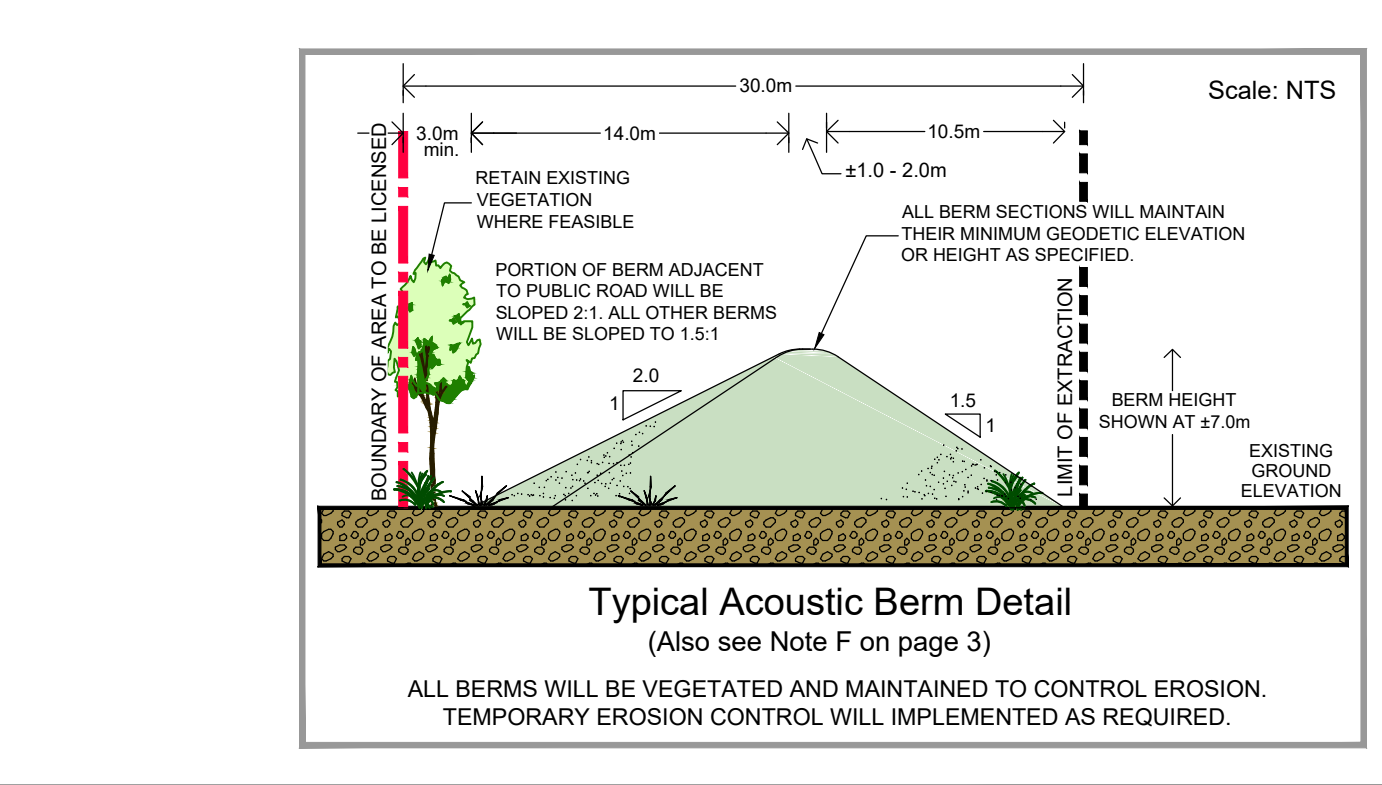
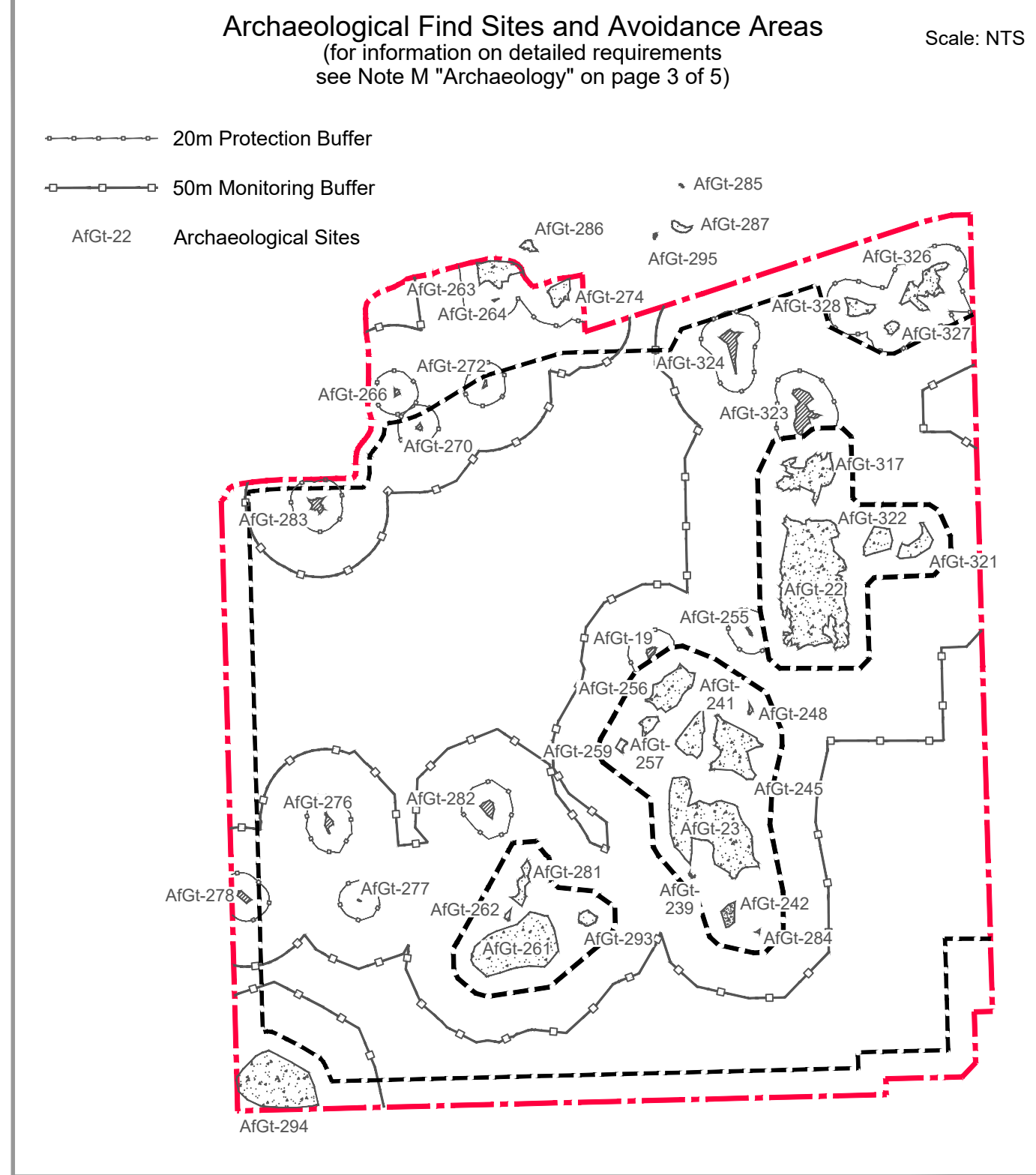
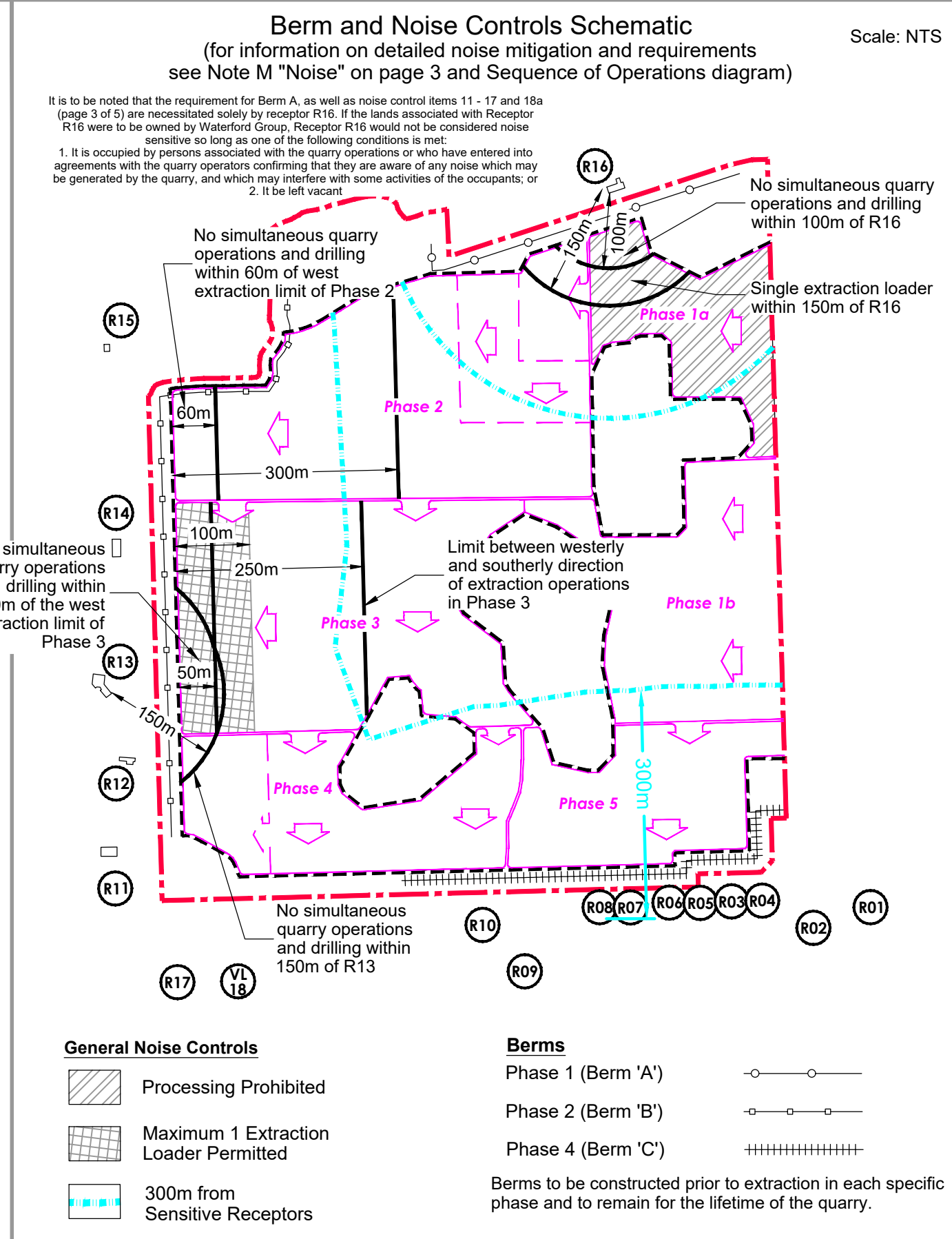
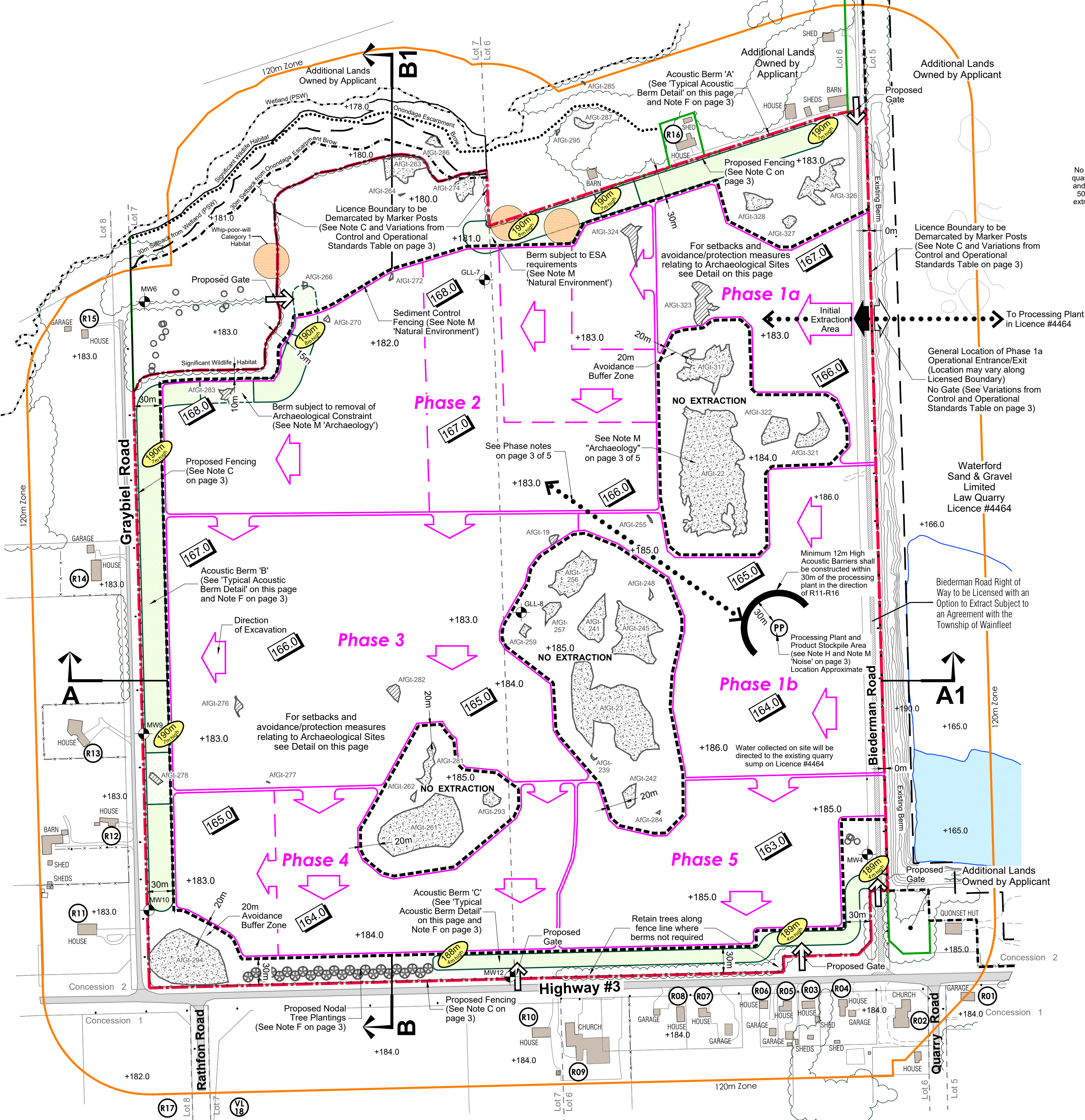

#### Legal Description

Part of Lots 6 & 7, Concession 2 and Part of Road Allowance Between Lots 5 & 6, Concession 2 (geographic Township of Wainfleet) Township of Wainfleet, Region of Niagara

#### Legend

- Boundary of Area to be Licensed
- Existing Licensed Boundary
- Existing Spot Elevation
- Existing Fence
- Building/Structure
- Existing Field Access
- Monitoring Well
- Existing Vegetation
- Permanent Exclusion Archaeological Sites
- Temporary Avoidance Archaeological Sites
- Cross Sections
- Limit of Extraction
- Additional Lands Owned by Applicant
- Operational Entrance
- General Direction of Excavation
- Proposed Acoustic Berm
- Proposed Fence
- Proposed Spot Elevation
- Noise Receptor
- Internal Haul Road
- Tree Plantings
- Spoon-leaved Moss
- Whip-poor-will Category 1 Habitat

#### Site Plan Amendments

No.	Date	Description	By

200 - 540 BINGEMANS CENTRE DR. KITCHENER, ON. N2B 3X9 | P: 519.574.3650 F: 519.574.0121 | WWW.MHBCPLAN.COM

## PLANNING URBAN DESIGN & LANDSCAPE ARCHITECTURE

# MHBC

NDMNR Approval Stamp

MHBC Stamp

Applicant

**Waterford Sand & Gravel Limited**  
 70 Ewart Avenue  
 Brantford, Ontario  
 N3T 5M1  
 Tel: (519) 752-1300

Applicant's Signature  
 Ed Lamb  
 VP/GM Construction Materials

Project

## Law Quarry Extension

Part of Lots 6 & 7, Concession 2  
 Part of Road Allowance Between Lots 5 & 6, Concession 2  
 (Geographic Township of Wainfleet) Township of Wainfleet, Regional Municipality of Niagara

ARA Licence Reference No. \_\_\_\_\_

Pre-approval review:

For Submission to NDMNR - June 2022

Plan Scale 1:2,500 (Arch D)

Plot Scale 1:2.5 [1mm = 2.5 units] MODEL

Drawn By D.G.S. File No. \_\_\_\_\_

Checked By C.P. File No. **0956B**

File Name **OPERATIONAL PLAN**

Drawing No. **2 OF 5**

K:\0956C-WATERFORD SAND AND GRAVEL LIMITED-LAW QUARRY EXTENSION\A\OPERPLAN 2OF5 JUNE2022.DWG